

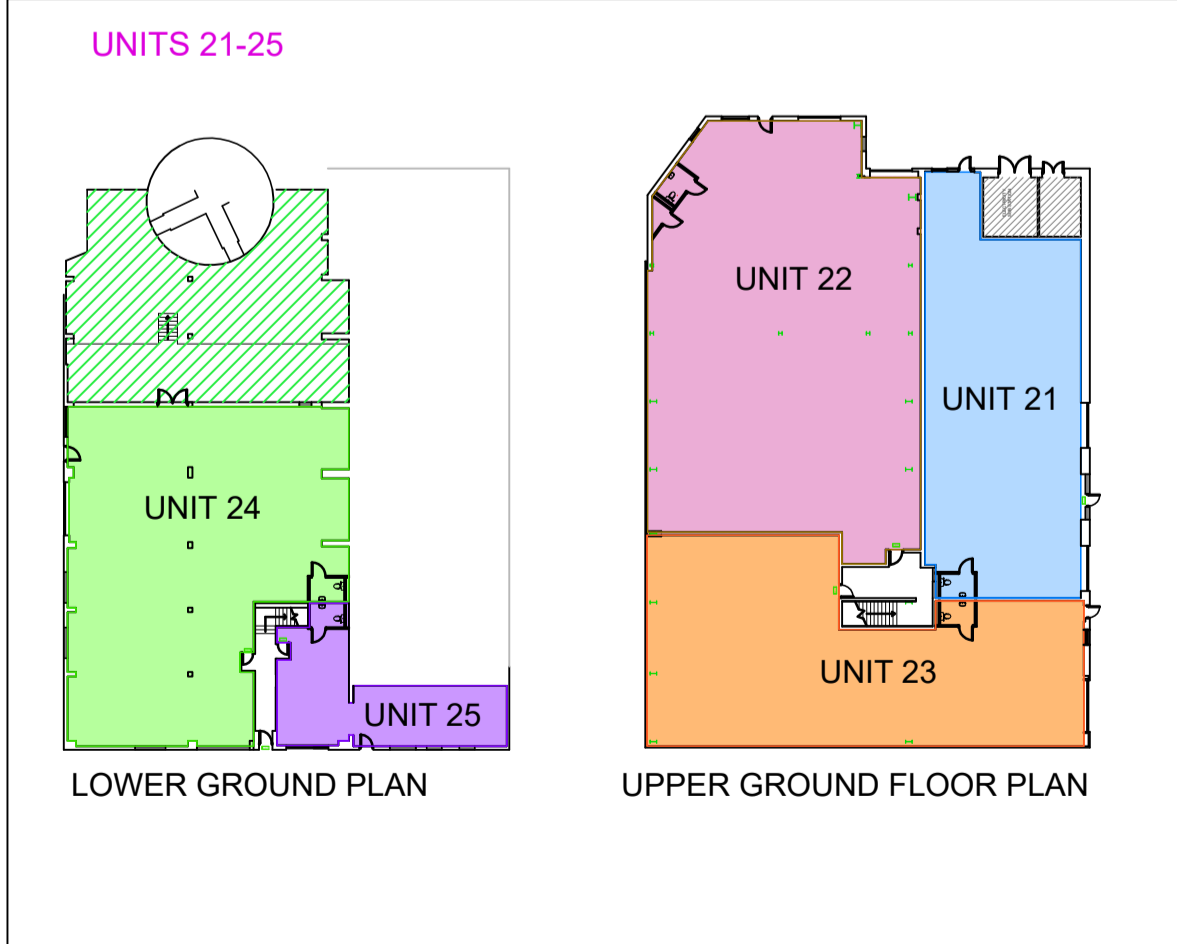

- 11 no. HYBRID UNITS
- 27 no. INDUSTRIAL UNITS
- 5 no. INDUSTRIAL UNITS



1. CHECK ALL DIMENSIONS ON SITE PRIOR TO WORK COMMENCING
 2. CONTRACTOR TO REPORT ANY DISCREPANCIES TO ELDER LESTER ARCHITECTS
 3. ORDINANCE SURVEY DATA IS USED ON ELDER LESTER DRAWINGS, ELDER LESTER IS NOT RESPONSIBLE FOR THE ACCURACY OF DIMENSIONS RELATING TO ORDINANCE SURVEY DATA OR THAT OUTSIDE OF INSERTED TOPOGRAPHIC SURVEY INFORMATION
 4. WORK WITHIN THE CONSTRUCTION (DESIGN & MANAGEMENT) REGULATIONS 2015 IS NOT TO START UNTIL A HEALTH & SAFETY PLAN HAS BEEN PRODUCED (BY OTHERS)
 5. THIS DRAWING IS FOR USE BY THE CLIENT ONLY AND FOR THE LOCATION SPECIFIED. COPYRIGHT & ANY DESIGNS THEREIN ARE THE PROPERTY OF ELDER LESTER ARCHITECTS & MUST NOT BE COPIED WITHOUT WRITTEN AGREEMENT



PROJECT/CLIENT:
 INDUSTRIAL DEVELOPMENT
 LAND ADJACENT TO A6085
 LEMINGTON
 NEWCASTLE UPON TYNE
 THE MANDALE GROUP

DRAWING INFORMATION:
 MASTER SITE LAYOUT
 SALES

RECENT REVISION NOTES:
 REV C - 05/09/2023 - DRAWING SIMPLIFIED FOR SALES PORTFOLIO. THE CONE ADDED TO INDUSTRIAL UNITS.
 REV D - 28/09/2023 - UNIT NUMBERS AMENDED

ELDER LESTER ARCHITECTS
 REEDS MILL, ATLAS WYND,
 YARM
 TS15 9AD
 TEL: 01642 782211
 WWW.ELDERLESTER.CO.UK



SCALE & PAPER SIZE: 1:500 @ A1
 DATE CREATED: 15/08/2023
 DATE OF LAST ISSUE: 28/09/2023
 DRAWN/ISSUED BY: MAS
 DRAWING No: 22-41-MSP-D